

Ecco HVLP – The efficient spray gun

For the most professional and environmentally conscious painting

Ecco HVLP spray guns are atomizing the paint at a low air pressure (0.7 bar), with a minimum of over spray and noise level. Ecco HVLP really contributes to better working conditions.

The paint saver

The paint transfer efficiency is at least 65% which means that 2/3 of the paint sprayed ends up on the work piece.

The highest demands of finishing quality

For all applications; touch-up jobs as well as production lines Ecco HVLP guns offer a perfect atomization with first class finish.

Regardless of the material being sprayed

Skilled engineers have with the help of sophisticated technology developed a full range air caps and paint nozzles that will ensure first class finish for most all sprayable materials.

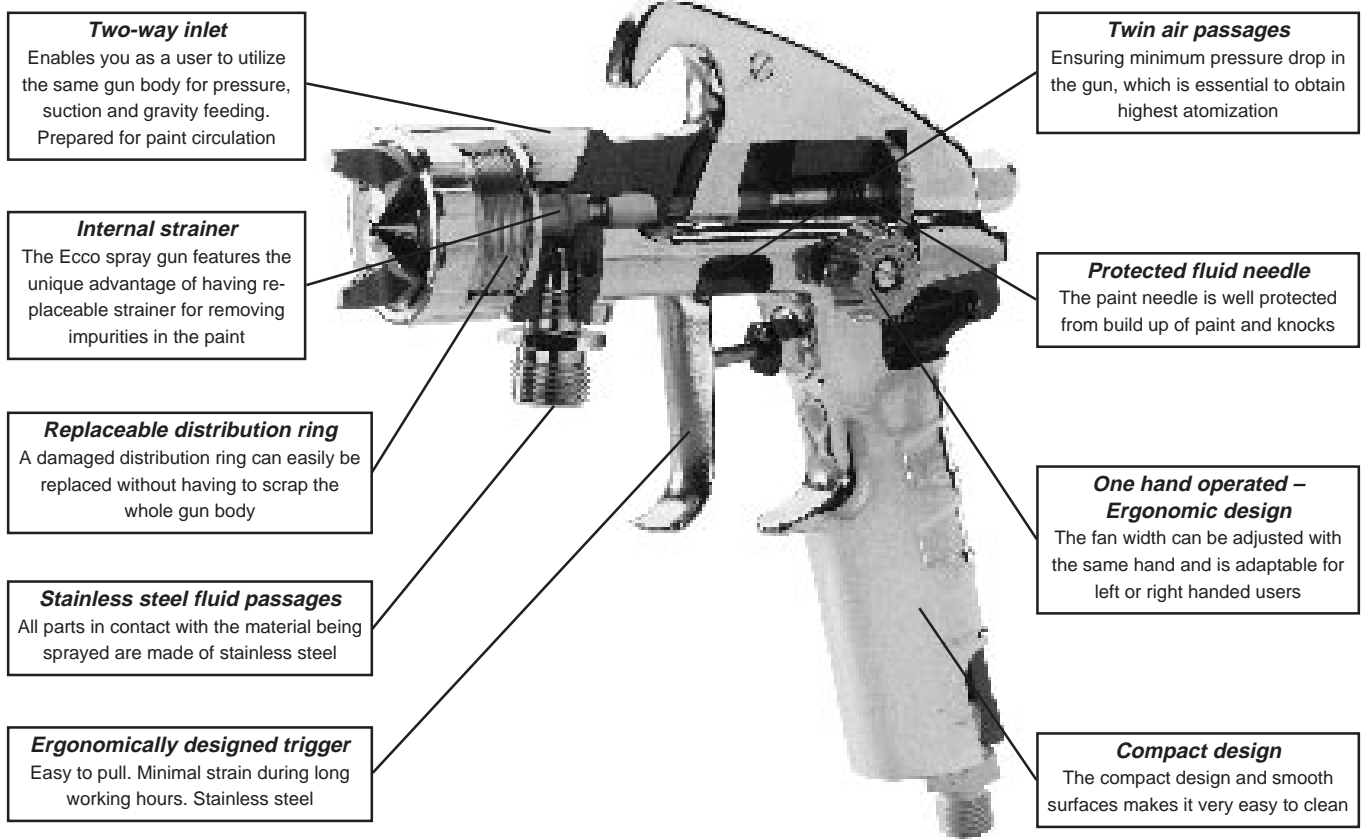

Two-way inlet

Enables you as a user to utilize the same gun body for pressure, suction and gravity feeding. Prepared for paint circulation

Internal strainer

The Ecco spray gun features the unique advantage of having replaceable strainer for removing impurities in the paint

Replaceable distribution ring

A damaged distribution ring can easily be replaced without having to scrap the whole gun body

Stainless steel fluid passages

All parts in contact with the material being sprayed are made of stainless steel

Ergonomically designed trigger

Easy to pull. Minimal strain during long working hours. Stainless steel

Twin air passages

Ensuring minimum pressure drop in the gun, which is essential to obtain highest atomization

Protected fluid needle

The paint needle is well protected from build up of paint and knocks

One hand operated – Ergonomic design

The fan width can be adjusted with the same hand and is adaptable for left or right handed users

Compact design

The compact design and smooth surfaces makes it very easy to clean

Automatic HVLP spray gun

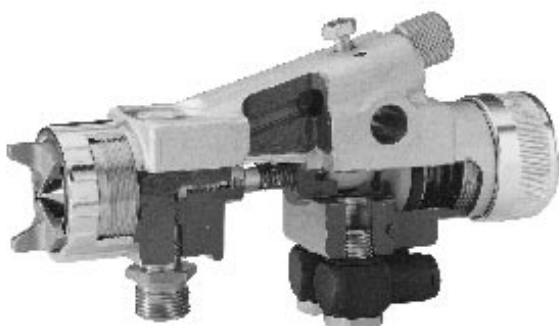

The Ecco HVLP automatic spray gun is durable and ensures excellent finish even at high production level.

- For mounting on robotic arms
- Simple and rigid mounting
 - precise alignment by locating pin
- Large paint supply control
 - exact settings with stepped positions
- Needle seal adjustable while the gun is operated
- Service friendly

Ecco HVLP – for all paint jobs

Ecco 65 S Pressure feed



Pressure feed HVLP spray gun. Fluid supplied from pressure pots, pumps or circulation systems.

Technical data	
Paint nozzles:	0.6 - 2.7 mm
Paint connection:	G 3/8
Air connection:	G 1/4
Air pressure:	3 bar
Air consumption:	approx. 260 l/min
Weight:	610 g

Selection of gun (paint nozzle size)

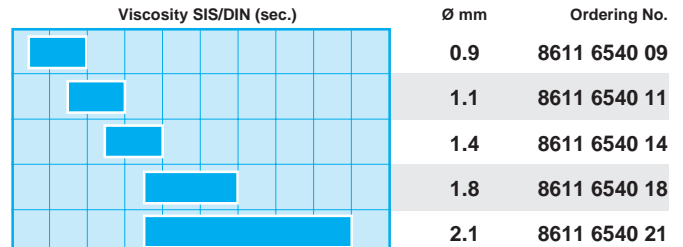

See also chart, page 14

Ecco 651 S Suction feed



Suction feed HVLP spray gun with 1.0 lit. suction cup.

Technical data	
Paint nozzles:	1.1 - 2.7 mm
Paint connection:	G 3/8
Air connection:	G 1/4
Air pressure:	3 bar
Air consumption:	approx. 260 l/min
Weight:	1 000 g

Selection of gun (paint nozzle size)

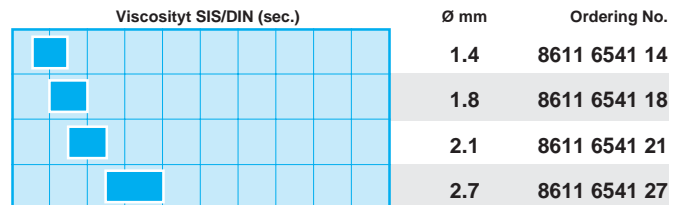

See also chart, page 11

Ecco 652 S Gravity feed



Gravity feed HVLP spray gun with 0.5 lit. swivelling cup with drip guard.

Technical data	
Paint nozzles:	0.9 - 2.7 mm
Paint connection:	G 3/8
Air connection:	G 1/4
Air pressure:	3 bar
Air consumption:	approx. 260 l/min
Weight:	760 g

Selection of gun (paint nozzle size)

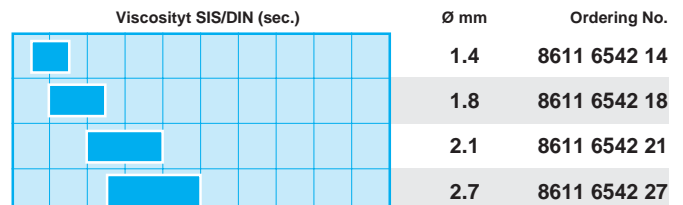

See also chart, page 11

Ecco 65 AS Automatic



Automatic HVLP spray gun.

Technical data	
Paint nozzles:	0.6 - 2.7 mm
Paint connection:	G 3/8
Air connection:	Quick coupling Ø 8 mm
Air pressure:	3 bar
Control air pressure:	4 - 7 bar
Air consumption:	approx. 260 l/min
Weight:	800 g

Selection of gun (paint nozzle size)

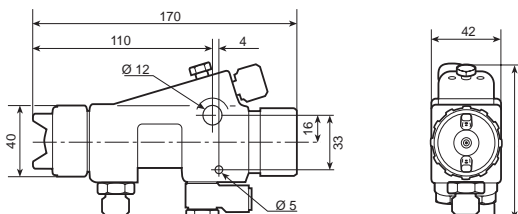
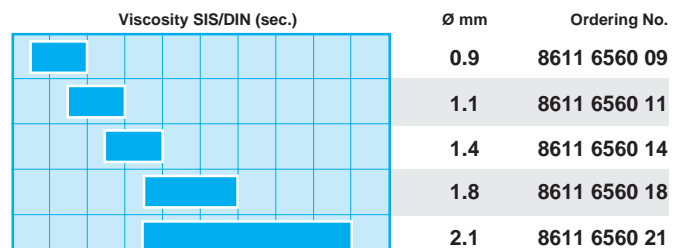

Ecco Spray Pack – ready-to-use spraying units

The Ecco Spray Pack equipment is based on the ready-to-use principle. A Spray Pack unit consists of all the equipment necessary to start to spray.

Although we have chosen the most commonly used guns and pumps, you can select the equipment to create your own Spray Pack.

Gravity feed

Ideal equipment when spraying small amounts of paint and frequent colour changes. Suitable for viscosity between 5 - 15 sec. (SIS/DIN).



Type	Ord. No.
Spray Pack 611	8613 2311 14
• Spray gun Ecco 652 S incl. paint nozzle Ø 1.4 mm	8611 6542 14
• Air filter/regulator LR 510 R	8202 0212 52
• Air hose, Ø 8 mm (5/16"), L= 8 m incl. coupl.	6003 7363 08

Suction feed

Perfect equipment when spraying small amounts of paint and frequent colour changes. Suitable for viscosity between 15 - 25 sec. (SIS/DIN)



Type	Ord. No.
Spray Pack 612	8613 2311 32
• Spray gun Ecco 651 S incl. paint nozzle Ø 2.1 mm	8611 6541 21
• Air filter/regulator LR 510 R	8202 0212 52
• Air hose, Ø 8 mm (5/16"), L= 8 m incl. coupl.	6003 7363 08

Pressure feed, cup 2.5 l

Suitable for continuous spraying and touch-up jobs. The capacity is approx. twice as much compared with suction fed guns. Suitable for viscosity between 15 - 30 sec. (SIS/DIN).



Type	Ord. No.
Spray Pack 613 B	8613 2311 39
• Spray gun Ecco 65 S incl. paint nozzle Ø 1.1 mm	8611 6540 11
• Pressure cup PRC 2, 2.5 l	8622 0100 00
• Air hose, Ø 6.3 mm (1/4"), L= 1.5 m incl. coupl.	6003 7360 97
• Paint hose, Ø 6.3 mm (1/4"), L= 1.5 m incl. coupl.	6003 7366 97

Pressure feed from 9 l tank

Suitable for continuous spraying and touch-up jobs. The capacity is approx. twice as much compared with suction fed guns. Suitable for viscosity between 15 - 30 sec. (SIS/DIN).



Type	Ord. No.
Spray Pack 614 B	8613 2311 48
• Spray gun Ecco 65 S incl. paint nozzle Ø 1.1 mm	8611 6540 11
• Pressure feed tank P9R 3.2, 9.0 l	8622 0116 09
• Air hose, Ø 8 mm (5/16"), L= 8 m incl. coupl.	6003 7363 08
• Paint hose, Ø 6.3 mm (1/4"), L= 8 m incl. coupl.	6003 7366 08

Ecco Feed Spray Pack

In the Ecco Feed Spray Packs the paint is circulated using air powered piston or diaphragm pumps. Compact and light equipment, ready-to-use and easy to clean.

An Ecco Feed Spray Pack consists of:

- Paint feeding pump with silencer and strainer
- Paint pressure regulator with gauge for precise

settings of the paint pressure. The regulator also works as a pulsation damper

- Reduction valve with gauge for precise settings of the air pressure
- An Ecco 65 S spray gun including a paint nozzle that can handle the most common fluids
- All the necessary valves, hoses and couplings
- Earthing device

Feeding from a diaphragm pump

For all types of paint, but particular suitable when spraying abrasive fluids. The paint feeding unit is mounted either on a lid for a 20 l paint container or on a bracket for wall mounting.



Type	Ord. No.
Spray Pack 605 (for container)	8613 2311 15
• Paint feeding unit Ecco Feed AT 15 L	8613 2311 30
• Spray gun Ecco 65 S incl. paint nozzle Ø 1.1 mm	8611 6540 11
• Air hose, Ø 8 mm (5/16"), L= 8 m incl. coupl.	6003 7363 08
• Paint hose, Ø 6.3 mm (1/4"), L= 8 m incl. coupl.	6003 7366 08
<i>Accessories:</i>	
• Stirrer ELM 40 F	8610 0112 05
Spray Pack 606 (for wall mounting)	8613 2311 16
<i>Same as Spray Pack 605, but with:</i>	
• Paint feeding unit Ecco Feed AT 15 B	8613 2311 40
<i>Accessories:</i>	
• Stirrer ELM 33 F-G 1	8610 0110 61

Technical data – Ecco Feed AT 15

The main component is a double-action diaphragm pump equipped with an inlet strainer. Suitable for pumping abrasive materials. The low utilization of the pump capacity contributes to a long service life. Wetted pump parts are made of teflon and acetal plastic.

Air outlet connection to gun:	G 1/4 male
Paint connection:	G 3/8 male
Air connection:	Quick coupling for 10 mm hose
Paint pressure:	max. 4 bar
Air pressure:	max. 6.8 bar
Pressure ratio:	1:1
Paint flow rate:	approx. 1.5 l/min
Air consumption:	approx. 10 l/min
Net weight:	9 kg

Feeding from piston pump

For all types of paint. Handy paint unit for quick paint changes. Mounted on a lid for 20 l paint container or on a tubular steel frame for use with different paint containers.



Type	Ord. No.
Spray Pack 617 B (for container)	8613 2311 81
• Paint feeding unit Ecco Feed A 2	8621 0210 08
• Spray gun Ecco 65 S incl. paint nozzle Ø 1.1 mm	8611 6540 11
• Air hose, Ø 8 mm (5/16"), L= 8 m incl. coupl.	6003 7363 08
• Paint hose, Ø 6.3 mm (1/4"), L= 8 m incl. coupl.	6003 7366 08
<i>Accessories:</i>	
• Stirrer ELM 33 F	8610 0110 63
Spray Pack 617 H (steel frame)	8613 2311 82
<i>Same as Spray Pack 617 B, but with:</i>	
• Paint feeding unit Ecco Feed A 2 H	8621 0210 32
<i>Accessories:</i>	
• Stirrer ELM 33 F-G 1	8610 0110 61

Technical data – Ecco Feed A 2

The main component is a single-action pump equipped with an inlet strainer. Design features that contribute towards a long service life include teflon piston rod gasket, chrome-plated stainless steel piston rod, nitrided stainless steel cylinder and a glass-fibre-reinforced teflon piston gasket.

Air outlet connection to gun:	G 1/4 male
Paint connection:	G 3/8 male
Air connection:	Quick coupling for 10 mm hose
Paint pressure:	max. 3 bar
Air pressure:	max. 7.5 bar
Pressure ratio:	1:2
Paint flow rate:	approx. 1 l/min
Air consumption:	approx. 10 l/min
Net weight:	9 kg

Accessories

Nozzle set

Consists of air cap, paint nozzle of stainless steel and paint needle of nylon. For all manual Ecco HVLP spray guns.

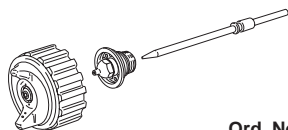

Paint nozzle Ø mm	Ord. No.
0.6	6003 9232 06
0.9	6003 9232 09
1.1	6003 9235 11
1.4	6003 9237 14
1.6	6003 9237 16
1.8	6003 9239 18
2.1	6003 9242 21
2.7	6003 9246 27

For ordering separate nozzles, see spare parts list.

Service kit

Contains gaskets and other wear components, incl. instructions.

For gun	Ord. No.
Ecco 65 S / 651 S / 652 S	6003 9095 00
Ecco 65 AS	6003 6572 00

Strainer insert

Strainer made of nylon. Fits behind the paint nozzle. For all manual Ecco HVLP spray guns.

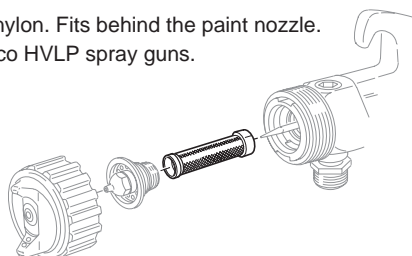

Mesh size	mesh	mm	Colour	Qty per set	Ord. No.
60	0.25	White	10	6103 3200 00	
100	0.15	Yellow	10	6103 3201 00	
200	0.07	Black	10	6103 3202 00	
300	0.05	Red	1	6103 1088 00	

Connecting pipe

To be mounted between the gun and the paint hose. Improves the balance and reduces the weight in the hand.

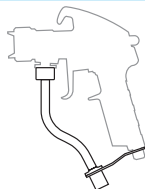

For gun	Ord. No.
Ecco 65 S	6001 3161 00

Cleaning brush

For cleaning nozzles and paint channels.



Diameter, mm	Ord. No.
10	6000 8004 00
17	6000 8001 00

Paint cup



Type	Volume, l	Weight, g	Ord. No.
Pressure cup for Ecco 65 S			
PRC 2	2.5	1 500	8622 0100 00
Suction cups for Ecco 651 S			
SD 10 aluminium	1.0	530	6803 4867 00
Extra cup SD 10 (without lid)	1.0		6803 4968 00
SD 10 T aluminium/teflon	1.0	530	6803 4869 00
Extra kopp SD 10 T (without lid)	1.0		6803 4969 00
SDT 15 aluminium/teflon	1.0	550	6003 9676 00
Extra kopp SDT 15 (without lid)	1.0		6003 9677 00
Gravity cup for Ecco 652 S			
Plastic cup	0.5	150	6101 5575 00

Strainer set for paint cup

Fits on the suction pipe with outside diam. 9 – 12 mm.



For cup	Size, mesh	Qty per set	Ord. No.
PRC 2, SD 10/T, SDT 15	80	10	6003 7886 00

Paint circulation set

Complete set of circulation pipe and couplings.



For gun	Ord. No.
Ecco 65 S (manual)	6103 3387 80
Ecco 65 AS (automatic)	6003 9670 00

Viscosity cup

Cup made of plastic or aluminium for measuring the viscosity.



Type	Ord. No.
Plastic	6803 3567 00
Aluminium	6003 7582 00

Accessories

Air filter/Pressure regulator



Dry and clean air at a constant pressure is an important factor to achieve a good result when spraying.

LR 510 R is an efficient combined air filter, water trap and pressure regulator. Compact design and easy maintenance ensures high reliability. It is easy to install. Wall bracket included.

It is equipped with reduction valve and gauge. Two guns can be connected at the same time. The air filter will collect particles larger than 15 µ.

Technical data	
Inlet connection thread:	G 1/2 female
Outlet connection thread:	G 1/4 male
Max. working pressure - primary:	14 bar
- secondary:	8 bar
Capacity at a primary circuit pressure at 6 bar:	1 500 l/min

Type	Ord. No.
LR 510 R	8202 0212 52

Air hose/Coupling



Despite its strength it is flexible enough to accompany the gun movements. Per metre or in standard 8 m lengths incl. couplings G 1/4 female with cap nut.

Inside diam.	Ord. No.	Ord. No.	Ord. No.
mm inch	per metre	coupling G 1/4	compl. 8 m
6.3 1/4	6003 6686 00	6001 1235 00	6003 7360 08
*8.0 5/16	6003 7346 00	6003 7338 00	6003 7363 08
9.5 3/8	6803 6687 00	6001 1239 00	6203 1460 08

* Recommended for lengths shorter than 10 m.

Paint hose/Coupling



Eccoflex is resistant to paints, solvents, weak acids or water at temperatures of up to +100°C. Outer sheathing of reinforced polyester and the inner hose of nylon. Per metre or in standard 8 m lengths incl. couplings G 3/8 female with cap nut.

Inside diam.	Ord. No.	Ord. No.	Ord. No.
mm inch	per metre	coupling G 3/8	compl. 8 m
*6.3 1/4	6803 6684 00	6003 5629 00	6003 7366 08
9.5 3/8	6803 6685 00	6001 1241 00	6003 7369 08

* Recommended for lengths shorter than 10 m.

Nylon hose/Coupling

Resistant and flexible hose of nylon for air or paint, inside diam. 6 mm.

Type	Ord. No.
Nylon hose, per metre	6003 6884 00
Coupling G 1/4 with cap nut	6003 7341 00
Coupling G 3/8 with cap nut	6003 7342 00

Quick coupling

Quick couplings for air with hole diam. 7 mm.

Connection type	Ord. No.
6.3 mm (1/4") - Coupling QIC 10A H06	8202 1302 02
8 mm (5/16") - Coupling QIC 10A H08	8202 1302 10
10 mm (3/8") - Coupling QIC 10A H10	8202 1302 28
G 1/4 - Coupling QIC 10A M8	8202 1302 36
G 3/8 - Coupling QIC 10A M10	8202 1302 44
6.3 mm (1/4") - Nipple NIP 10A H06	8202 1202 11
8 mm (5/16") - Nipple NIP 10A H08	8202 1202 94
10 mm (3/8") - Nipple NIP 10A H10	8202 1202 29
G 1/4 - Nipple NIP 10A M08	8202 1202 45
G 1/4 - Nipple NIP 10A F08	8202 1202 86

Jointing nipple

Jointing nipples with cone for hose coupling at one end.



Thread male	Hole Ø mm	Material	Ord. No.
G 1/4 - G 1/4	7	Nickle-plated brass	6001 2619 00
G 1/4 - 9/16 20G	7	Nickle-plated brass	6000 1877 00
G 1/4 - G 3/8	7	Nickle-plated brass	6001 2617 00
G 3/8 - G 3/8	7	Nickle-plated brass	6001 3156 00
G 3/8 - G 3/8	9.5	Zinc-plated steel	6803 1250 00

Hose clamp

Delivered in set of 5 pcs.

For hose with outer diam. mm	Ord. No.
7.0 - 8.5	0347 0122 05
8.5 - 10.0	0347 0122 06
9.8 - 11.8	0347 0122 07
11.3 - 13.3	0347 0122 08
12.8 - 14.8	0347 0122 09
14.6 - 16.8	0347 0122 10
16.5 - 18.8	0347 0122 11

Hose nipple

Hose nipple G 1/4 male. For air and paint hose. Not for nylon.

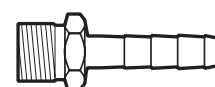

For hose with inner diam.		Ord. No.
mm	inch	
6.3	1/4	6000 3347 00
8.0	5/16	6003 7345 00
9.5	3/8	6000 4116 00

Paint and air valve



Connection thread	Hole diam. mm	Max. working pressure, bar	Ord. No.
G 1/4 male	6	16	6803 0300 00
G 3/8 male	9	16	6803 0301 00
G 1/4 female	7	40	6003 7774 00
G 3/8 female	7	40	6003 7775 00

Ecco Pressure Feed Tanks

Closed and safe paint handling

The Ecco Pressure Feed Tanks are suitable for all sprayable material and provide safe storage. Having almost no wearing parts they are first choice for paints with abrasive pigments.

To prevent the build up a static charge all of the tanks have an earthing device.

Complete, ready for start up

The tanks are made of galvanized steel and as standard equipped with regulator, pressure gauge, safety relief valve, re-filling port and ball valves for air and paint.

You just have to fill up paint and connect to air supply and spray gun.

Volume 9 – 90 litres. Other sizes or stainless steel versions available on request.

Pneumatic stirrer

For continuous stirring Ecco Pressure Feed Tanks with a manual stirrer can easily be equipped with an explosion proof air motor.

Top or bottom feed

For more viscous materials Ecco tanks with bottom outlet should be used.

Approved and safe

Ecco Pressure Feed Tanks conforms regarding material, design and safety standards with requirements set by the Swedish and German authorities The GS-marking of the tanks stand for tested for safety by the German Safety Control Board TÜV.

Ecco Pressure Feed Tank

Air connection: G 1/4 male. Paint connection: G 3/8 male.



Top feed

Type	Volume litre	Air pressure max., bar	Height mm	Inner diam. mm	Width mm	Weight kg	Ord. No.
P9R-3.2	9	3.2	520	210	330	6	8622 0116 09
P12R-6	12	6	545	245	350	25	8622 0116 12
P12RA-6*	12	6	695	245	350	27	8622 0116 13
P24R-6*	24	6	945	245	350	32	8622 0116 24
P45R-4*	45	4	885	360	470	46	8622 0116 45
P45R-6*	45	6	885	360	470	46	8622 0116 46
P90R-6*	90	6	1165	360/440	470	63	8622 0116 90

* With manual stirrer

Bottom feed

Type	Volume litre	Air pressure max., bar	Height mm	Inner diam. mm	Width mm	Weight kg	Ord. No.
P24RP-6	24	6	795	245	525	30	8622 0116 25
P45RP-4	45	4	735	360	645	44	8622 0116 47
P45RP-6	45	6	735	360	645	44	8622 0116 48

Air motor for stirrers

Explosion proof air powered motor for Ecco tanks with stirrers. Including bracket, quick coupling for air hose, speed control valve and silencer.

Air consumption at 100 – 150 rpm: 150 – 200 l/min.



Type	Ord. No.
ELM 33 P	8610 0110 60

Overflow protector

Facilitates the filling of Ecco Pressure Feed Tanks 12 – 500 litres.



Type	Ord. No.
StopFlow	6003 9157 00

Earthing device

To prevent the build up of a static charge when feeding inflammable fluids. Delivered complete with 6 m cable.



Type	Ord. No.
Earthing device	6203 0532 00

Personal protection

Fresh air hood Junior

Junior is recommended for spray painting. The hood will protect the wearer against dust and fumes. The large window which can be raised is covered by protective foil.

The Fresh air hood Junior includes innerhood, protecting foil (10 pcs.), air hose and belt with throttle valve with nipple for connection to air hose Ø 6.3 mm (1/4") female.

Air consumption: 150 – 200 l/min.



Type	Ord. No.
Fresh air hood Junior	8615 0133 35
Accessories	Ord. No.
Innerhood, set of 5 pcs.	6803 6678 00
Protecting foil, set of 100 pcs.	6803 6679 00

Air filter

Air filter for breathing air. Can be connected directly to the air supply. The filter will remove particles larger than 0.01 µ, oil fumes and odours. The filter **will not** remove methane, carbon monoxide or other toxic gases.



Technical data

Working pressure:	max. 6 bar
Normal working pressure to safety helmet:	3 bar
Air capacity:	420 l/min
Air connections:	G 1/4 female
Weight:	2.5 kg

Type	Ord. No.
Air filter AFR 13	8202 0216 26
Accessories	Ord. No.
Bracket for wall-mounting	6003 6764 00
Prefilter	9090 1762 00
Ceramic filter	1202 6257 01
Chemical filter	1202 6281 01

Breathing mask Max

A breathing mask should always be worn when working in the presence of strong solvents and paints. The rubber breathing mask covers the nose and mouth and is designed for use with goggles. The mask will protect the wearer against dust and organic gases.

A standard mask includes filter holder, prefilter and chemical filter.



Type	Ord. No.
Breathing mask Max	6803 3072 00
Accessories	Ord. No.
Prefilter	6802 9844 00
Chemical filter	6802 9845 00

Air thermostat Vortex

For air conditioning of fresh air helmets and hoods. The temperature of the breathing air (warm/cold) is adjustable.

An air thermostat Vortex includes hose nipple Ø 1/4" female. To be installed between air filter and helmet.



Type	Ord. No.
Air thermostat Vortex	8615 0133 36

Hose for breathing air

Air hose made of wear resistant PVC. Approved by Swedish Authorities. Delivered per metre. Outer diam. 11 mm.

Type	Ord. No.
Air hose, innerdiam. 1/4"	6003 9598 00
Coupling G 1/4 with cap nut and hose clamp	6001 1235 00
Quick coupling QIC 10A H06	8202 1302 02
Nipple NIP 10A H06	8202 1202 11
Hose clamp	0347 0122 07

Basic Spraying Technique

The low atomization pressure of 0.7 bar at the air cap reduces the air rebound and overspray. More of the paint leaving the gun will reach the surface.

But even with an adequate installation of the equipment and the right choice of paint it is essential that you are aware of the factors that influence the result.

The key elements in achieving quality finish results are the understanding of:

- **How the spray gun works**
- **The spray gun setup**
- **Why air cap and paint nozzle combinations need to be matched to specific jobs and material**
- **The spray techniques required**

Paint pressure

The paint pressure should be set as low as possible with respect to the required paint output.

If the paint pressure is set too high it could lead to a lack of air to atomize the paint.

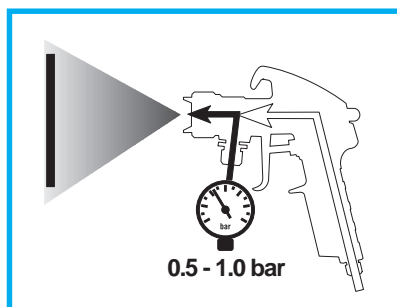

Air pressure

Be sure that the correct atomization air is connected regarding volume, pressure and quality (dry and clean).

The pressure at the nozzle, 0.7 bar is achieved when the inlet pressure is 3 bar at the gun.

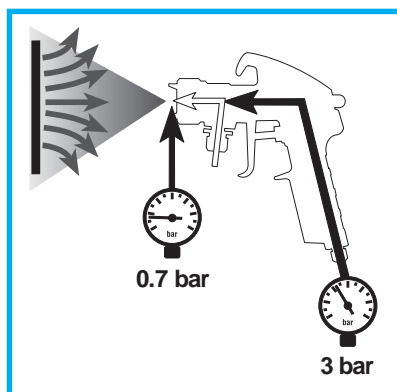

Fan width

All paint that does not reach the work piece will effect the environment and your paint economy.

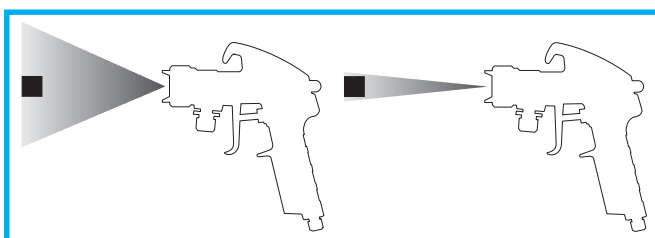

A fraction of the paint ends up on the work piece

With a significant lower paint output, the same amount ends up on the work piece

Distance to work piece

Regardless of the equipment chosen the distance to the work piece should be maintained as short as possible. This is a factor that will greatly influence your transfer efficiency.

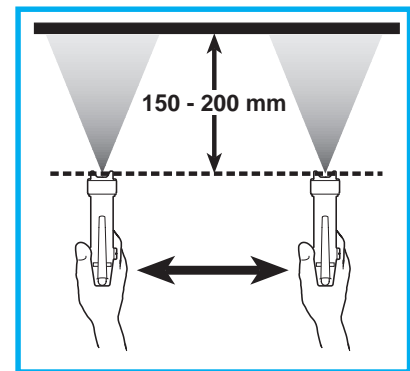

Strokes

Always point the gun at right angles to the surface you are painting. Spray in horizontal even and calm strokes. Edges, corners and hard to reach areas should be sprayed first. Finish with the larger visible areas by spraying from edge to edge without interrupting in the middle. 50% overlapping should be maintained.

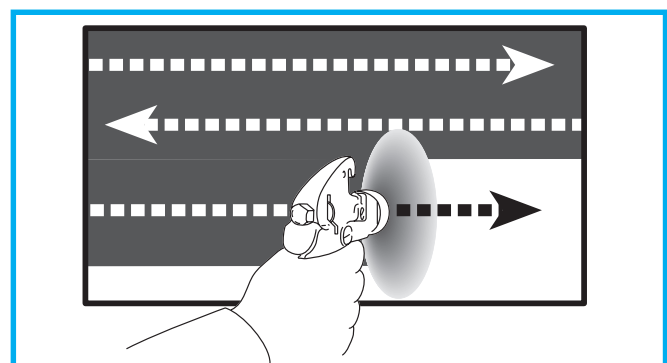

Cleaning the spray gun

At shorter stops in using the gun, for instance during the night, it is enough if the air cap and the paint nozzle are cleaned with soft brush soaked in solvent. At longer stops or storage always flush the gun through with solvent. Do not immerse the gun in solvent since it will dissolve the lubrication oil inside the gun.

The correct choice for your application

Pressure feed guns

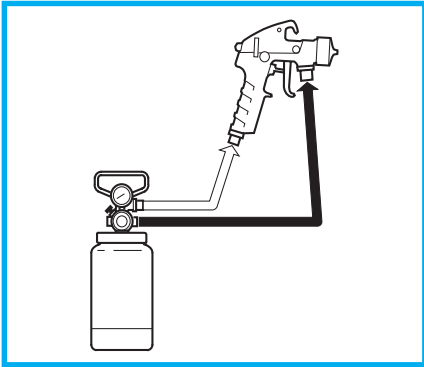

On pressure feed guns the paint is forced through the gun by either a pressure pot, pump unit or a circulation system.

This setup is suitable for continuous spraying and touch-up jobs.

Suction feed guns

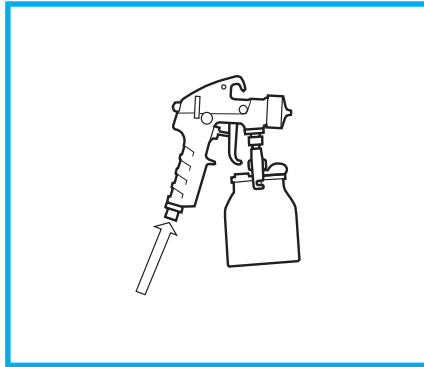

A stream of air through the gun creates a vacuum at the air cap and the paint is siphoned from the suction cup.

This setup is recommended for smaller paint jobs where frequent colour changes are required.

Gravity feed guns

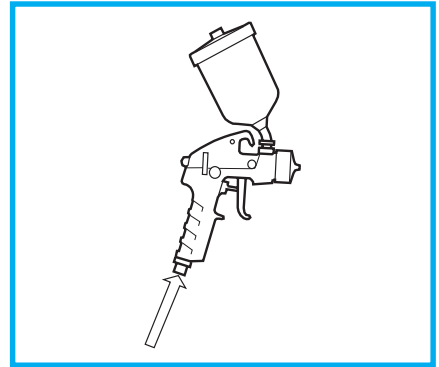

The paint is drawn to the paint nozzle by gravity, as well as the siphon effect of the air cap.

The capacity is slightly higher than suction feed guns and also the capability of handling more viscous materials.

Guidelines for selection of the most suitable spray gun

Below you will find a chart for the most suitable gun for arrange of different application.

The chart should be considered as a guideline only.

Method	Type of gun/ Paint nozzle diam., mm	Body Shop			Wood				Work Shop				Other				Ordering No.		
		All types	Metallic Top coat	High Solids	Base coat Top coat	Stain	Polyester	Glue (Latex or solvent based)	Primer	Rust proofing Epoxy	Fillers Putty	Epoxy	Enamel	Domestic appliance					
PRESSURE	65 S/0.9	🔫	🔫	🔫		🔫													8611 6540 09
	65 S/1.1				🔫				🔫		🔫	🔫							8611 6540 11
	65 S/1.4						🔫	🔫		🔫									8611 6540 14
	65 S/1.8												🔫						8611 6540 18
SUCTION	651 S/1.4					🔫													8611 6541 14
	651 S/1.8		🔫																8611 6541 18
	651 S/2.1	🔫		🔫	🔫				🔫	🔫		🔫		🔫					8611 6541 21
	651 S/2.7						🔫												8611 6541 27
GRAVITY	652 S/1.4		🔫			🔫													8611 6542 14
	652 S/1.8			🔫															8611 6542 18
	652 S/2.1	🔫			🔫				🔫			🔫		🔫					8611 6542 21
	652 S/2.7						🔫	🔫		🔫	🔫		🔫						8611 6542 27